



MAP 13

DEPARTMENT OF PLANNING
 ENVIRONMENTAL PLANNING & ASSESSMENT ACT, 1979
MURRAY REGIONAL ENVIRONMENTAL PLAN No. 2
 - RIVERINE LAND

- INDEX
- FLOOD LIABLE LAND
 - NATIVE VEGETATION
 - WETLANDS / STREAMS
 - R.E.P. BOUNDARY
 - STATE BOUNDARY AND R.E.P. BOUNDARY
 - L. G. A. BOUNDARY
- See Note

RIVER MURRAY
MAPPING

Orthophoto base map and base information (flood liable land, wetlands & native vegetation) provided by the Murray-Darling Basin Commission
 Copyright Reserved, 1992

Licensed supplier: NSW Department of Planning, Licence Number 1
 Enhancement of information on base maps by Department of Planning

Limitations: This orthophoto base map has been prepared to 1:25 000 cartographic standards. Scale distortions and inaccuracies will occur when enlarged beyond this scale.

Note: Where flood liable land, vegetation, or wetland boundaries coincide, only one line is shown.

River Murray Mapping Series:	Date of Photography
Berara	5-67 (91)
Torumberry Weir	3-68 (91)

Index to Adjoining Sheets

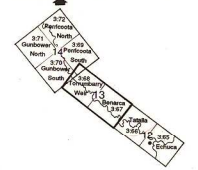

Sheet 13 of 52 sheets



DRAWN BY	CARTOGRAPHIC	NOTATIONS
CHECKED	CARTOGRAPHIC	Replaces Murray Regional Environmental Plan No. 1 - Murray River Riparian Land
BY	PLANNING OFFICER	GOV. GAZ. OF